

- NOTE:
- Proposals must comply with all acoustic, fire & building regulation requirements
 - No dimensions are to be scaled from this drawing. The contractor is responsible for checking all dimensions on site

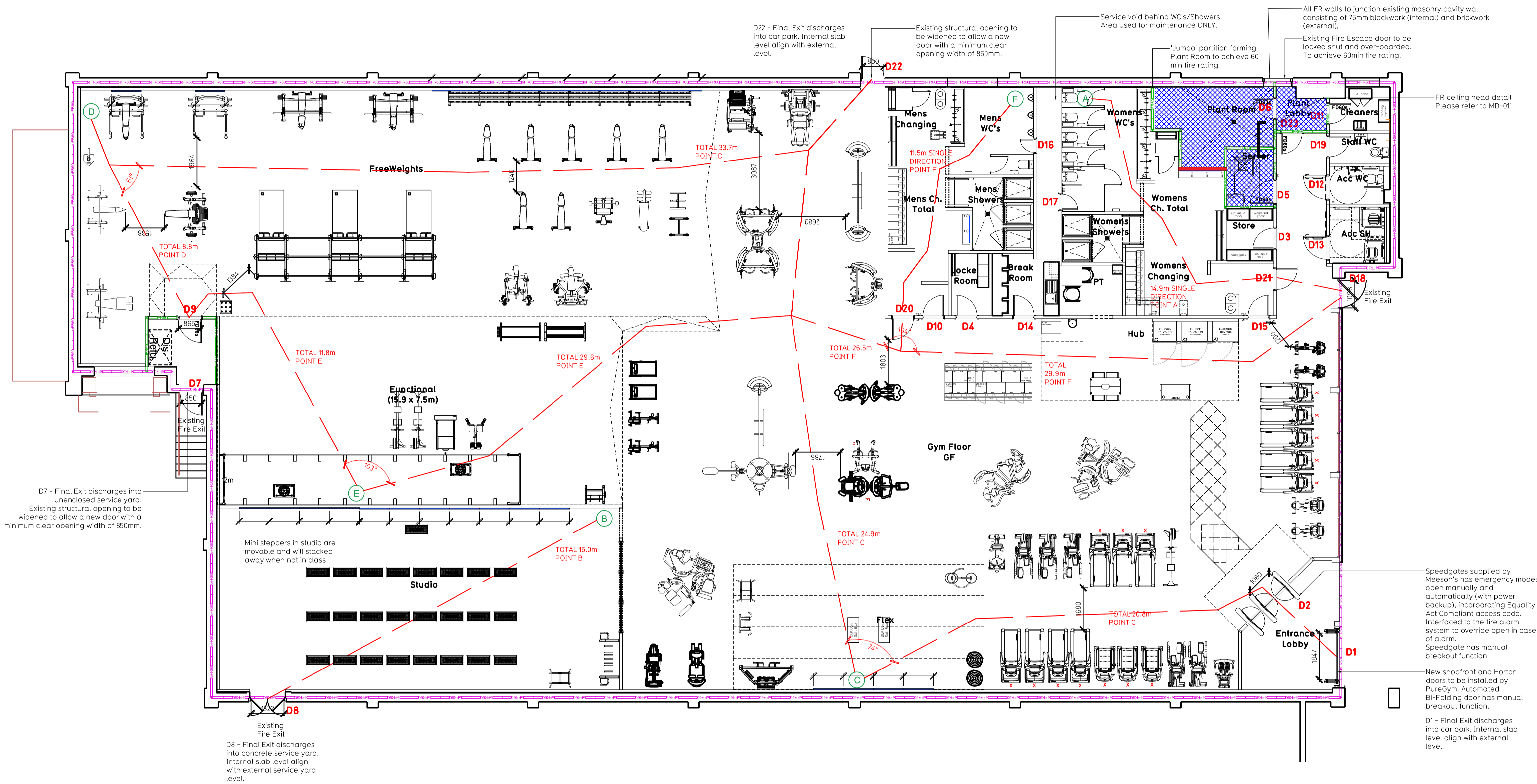

Escape Distance and Angle of Divergence

Position A
 Total escape to nearest Final Exit D18 = 14.9m
 The total escape distance is less than 15m and thus complies.

Position B
 Total escape to nearest Final Exit D8 = 15.0m
 The total escape distance is less than 15m and thus complies.

Position C
 Total escape distance to nearest Final Exit D1 = 20.5m
 Distance before divergence is 0.0m
 A.O.D to be > (2.5 X 0.0) + 45 = 45°
 Drawn A.O.D = 74° thus complies.

Position D
 Total escape distance to nearest Final Exit D9 = 9.0m
 Distance before divergence is 1.9m
 A.O.D to be > (2.5 X 1.9) + 45 = 49.75°
 Drawn A.O.D = 61° thus complies.

Position E
 Total escape distance to nearest Final Exit D9 = 11.8m
 Distance before divergence is 0.0m
 A.O.D to be > (2.5 X 0.0) + 45 = 45°
 Drawn A.O.D = 103° thus complies.

Position F
 Total escape distance to nearest Final Exit D22 = 26.5m
 Distance before divergence is 11.5m
 A.O.D to be > (2.5 X 11.5) + 45 = 74°
 Drawn A.O.D = 164° thus complies.

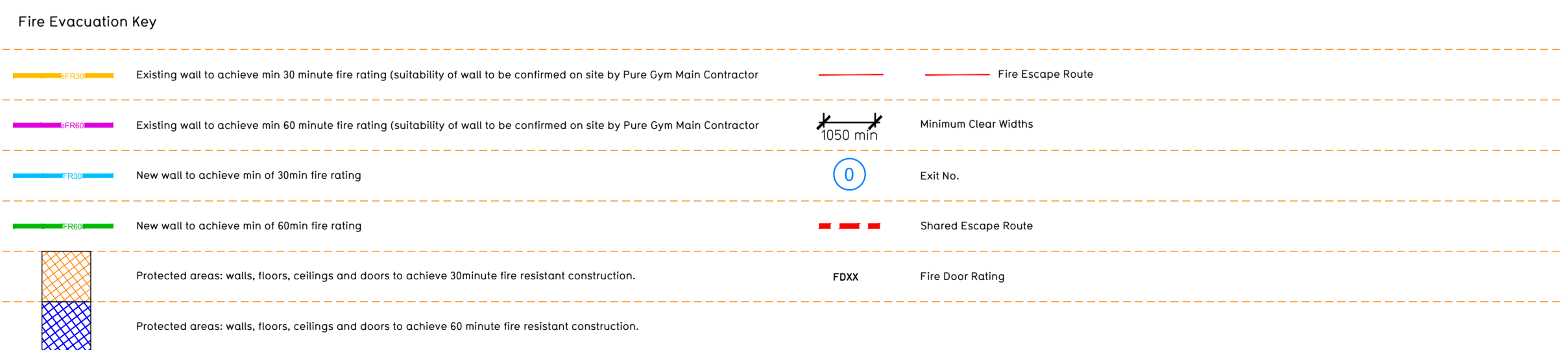

Escape Route Widths

In line with Section 2.9.8 of the Technical Handbook - Non Domestic, the aggregate unobstructed width in mm of all escape routes from a room, or storey, should be at least 5.3 x the occupancy capacity of the room or storey.

Ground Floor

Aggregate Clear Opening Width of Escape Routes Calculation:
 Final Fire Exit D1 clear opening width = 1812mm (allows 375 persons to escape) but is limited by D2 clear opening width = 1050mm (allows 222 persons to escape).
 Final Fire Exit D5 clear opening width = 1322mm (allows 272 persons to escape).
 Final Fire Exit D8 clear opening width = 867mm (allows 225 persons to escape) but is limited by D7 clear opening width = 850mm (allows 225 persons to escape).
 Final Fire Exit D18 clear opening width = 1098mm (allows 275 persons to escape).
 Final Fire Exit D22 clear opening width = 850mm (allows 225 persons to escape).

Total Aggregate Width for Floor (Less Largest Opening Width of 1322mm from Exit D8) = 3858mm
 Ground Floor Total Estimated Occupancy Capacity = 20 Persons
 Ground Floor Maximum Occupancy Capacity = Total Aggregate Width for Floor (Less Largest Opening Width of 1322mm from Exit D8) ÷ 5.3 = 727 people

Combined Occupancy Provision

Ground floor maximum occupancy: 727 NO.
 TOTAL occupancy provision: 727 NO.

Based on PG existing occupancy data at 340+ Pure Gyms of comparable sites, Pure Gym Airdrie is designed for a peak occupancy of 207 people. This is smaller than the max. no of 727 persons (see calculation above). Therefore thought to meet with the Section 2.9 of Technical Handbook - Non Domestic.

It is also important to note that 207 people is the occupancy figure, Pure Gym Airdrie's average occupancy during everyday operation will likely be approx. 50% lower than peak hour occupancy.

Sprinklers
 System design and installed in compliance with BS EN 12845:2015 & LPC Technical Bulletins

Fire Alarm
 Fire Alarm designed and installed to BS 5839. Smoke & heat detection / emergency lighting by specialist. Please refer to MSE engineer's drawings / specifications.

Smoke Extract
 Smoke Extract System to be designed and installed in accordance with BS 7346: Part 8. Please refer to MSE Engineer's drawings for final layout and specifications.

Fire Stopping
 All perimeter edges of mezzanine to be appropriately fire stopped to create compartment floor and protect mezzanine structure. All services/drainage penetrations passing through fire rated compartment floor to be fire collared/sealed.

Escape Signage and emergency lighting is CDP under the MSE specification. Details of contractors proposals to be provided to Building Control Approved Inspector and Fire Officer within the Contractors Proposals Package, Clause 14

Rev	Date	Description	DRAWING TITLE	Drawn/ Checked
SK/KL	04.12.23	1:100 @ A1	2252	003-FEP

CONSTRUCTION

PUREGYM

Pure Gym Ltd
 Town Centre House
 The Meriton Centre
 Leeds
 LS2 9LY

e: architecture@puregym.com
 t: 0113 285 6787
 w: www.puregym.com