

- NOTE:
- Proposals must comply with all acoustic, fire & building regulation requirements
  - No dimensions are to be scaled from this drawing. The contractor is responsible for checking all dimensions on site

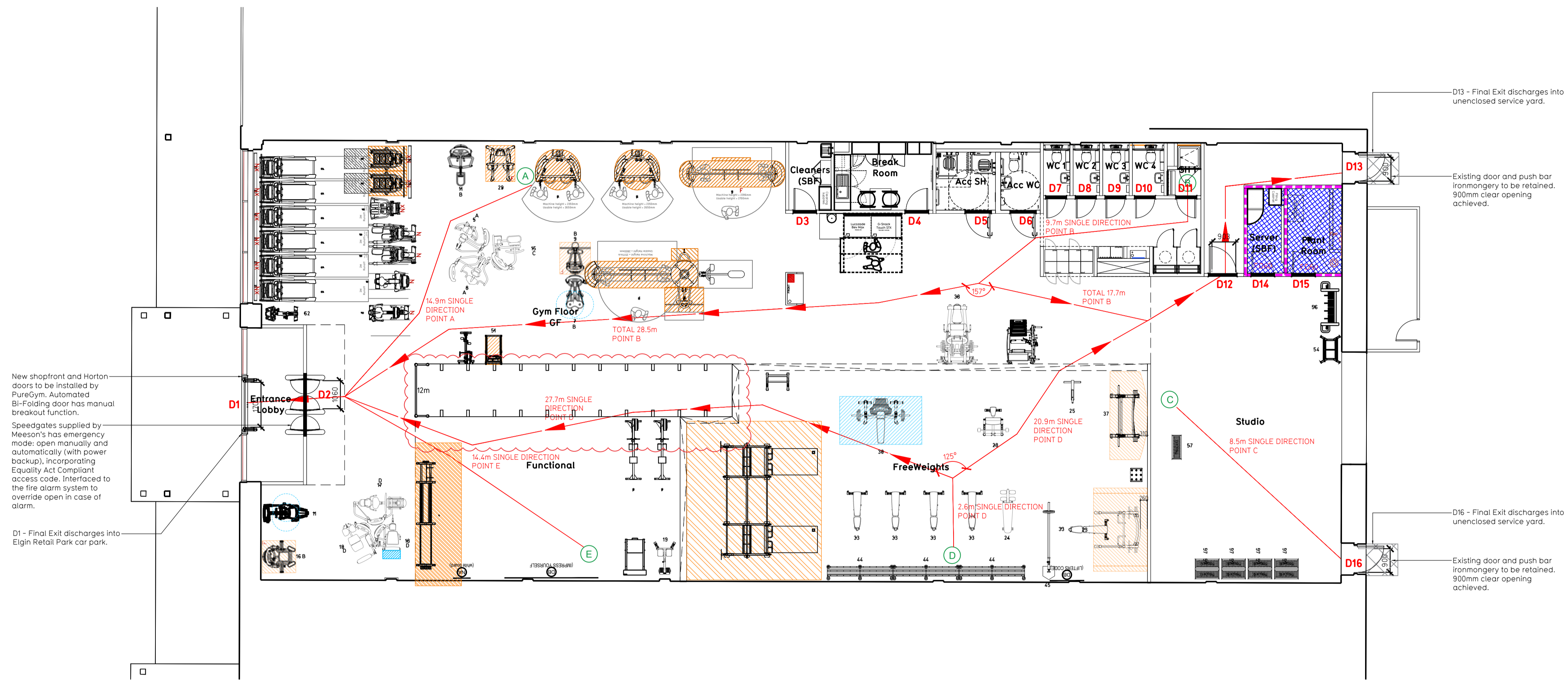

Proposed Ground Floor Plan

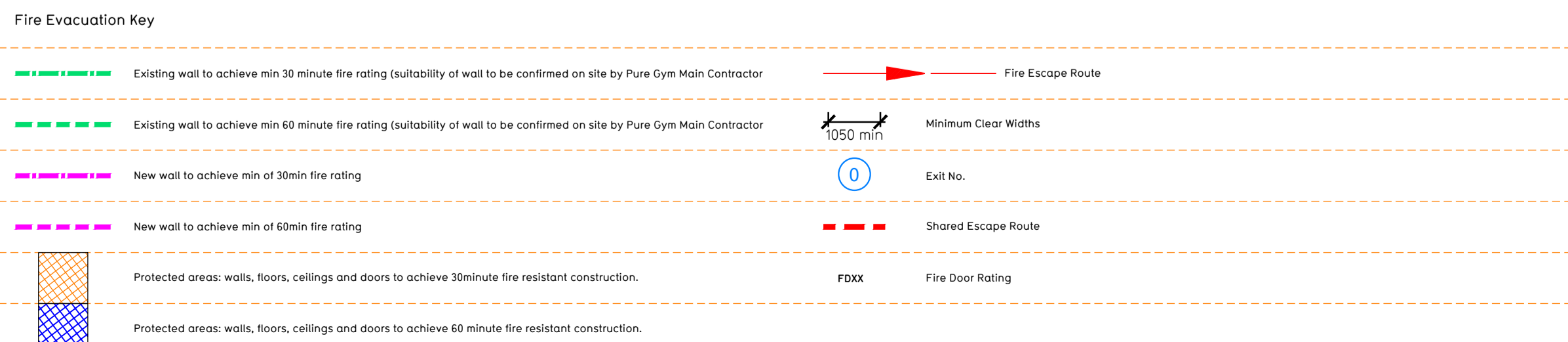

**Escape Route Widths**  
 In line with Section 2.9.8 of the Technical Handbook - Non Domestic, the aggregate unobstructed width in mm of all escape routes from a room, or storey, should be at least 5.3 x the occupancy capacity of the room or storey.

**Ground Floor**  
**Aggregate Clear Opening Width of Escape Routes Calculation:**  
 Final Fire Exit DR1 clear opening width = 1100mm (allows 350 persons to escape) but is limited by DR2 clear opening width = 1060mm (allows 322 persons to escape)  
 Final Fire Exit DR13 clear opening width = 900mm (allows 100 persons to escape)  
 Final Fire Exit DR16 clear opening width = 900mm (allows 100 persons to escape)

**Total Aggregate Width for Floor (Less Largest Opening Width of 1060mm from EXIT NO DR2) = 1800mm**  
 Ground Floor Total Estimated Max. Occupancy Capacity = 100 persons  
 Ground Floor Maximum Occupancy Capacity = Total Aggregate Width for Floor (Less Largest Opening Width of 1060mm from EXIT NO DR2) ÷ 5.3 = 339 persons

**Combined Occupancy Provision**  
 Ground floor maximum occupancy: 339 persons  
 Total occupancy provision: 339 persons

Based on PG existing occupancy data of comparable sites, the average total occupancy of a Pure Gym at this size will be unlikely to exceed 100 people, which sits in line with the proposed sanitaryware provision (section 3.12.5) and is smaller than the max. no. of 339 persons (see calculation above). Therefore thought to meet with the Section 2.9 of Technical Handbook - Non Domestic.

**Escape Distance and Angle of Divergence**

**Position A**  
 Total escape to nearest Final Exit DR1 = 14.9m  
 The total escape distance is less than 15m and thus complies.

**Position B**  
 Total escape distance to nearest Final Exit DR13 = 27.4m  
 Distance before divergence is 9.7m  
 A.O.D to be > (2.5 X 9.7) ÷ 45 = 69.25°  
 Drawn A.O.D = 157° thus complies

**Position C**  
 Total escape to nearest Final Exit DR16 = 8.5m  
 The total escape distance is less than 15m and thus complies.

**Position D**  
 Total escape distance to nearest Final Exit DR13 = 23.5m  
 Distance before divergence is 2.6m  
 A.O.D to be > (2.5 X 2.6) ÷ 45 = 51.5°  
 Drawn A.O.D = 129° thus complies

**Position E**  
 Total escape to nearest Final Exit DR1 = 14.4m  
 The total escape distance is less than 15m and thus complies.

**Fire Alarm**  
 Fire Alarm designed and installed to BS 5839. Smoke & heat detection / emergency lighting by specialist. Please refer to M&E engineer's drawings / specifications.

**Escape Lighting**  
 Emergency escape lighting designed and installed in accordance with BS 5266: Part 1. Please refer to M&E Engineer's drawings for final layout and specification.

Escape Signage and emergency lighting is COP under the M&E specification. Details of contractors proposals to be provided to Building Control Approved Inspector and Fire Officer within the Contractors Proposals Package, Clause 14

Rev	Date	Description	DRAWING TITLE	Drawn/Checked												
C02	09.10.23	Updates clouded red	Elgin Unit 6, Elgin Retail Park, Edgar Road, IV30 6RP Fire Evacuation Plan Ground Floor Plans	SK/HB												
C01	21.09.23	Updates clouded red		HB												
<table border="1"> <thead> <tr> <th>DRAWING PURPOSE</th> <th>DATE</th> <th>SCALE</th> <th>ISS. NO.</th> <th>DRAWING NO.</th> <th>Rev</th> </tr> </thead> <tbody> <tr> <td>CONSTRUCTION</td> <td>30.08.23</td> <td>1:100 @ A1</td> <td>2273</td> <td>003-FEP</td> <td>C02</td> </tr> </tbody> </table>					DRAWING PURPOSE	DATE	SCALE	ISS. NO.	DRAWING NO.	Rev	CONSTRUCTION	30.08.23	1:100 @ A1	2273	003-FEP	C02
DRAWING PURPOSE	DATE	SCALE	ISS. NO.	DRAWING NO.	Rev											
CONSTRUCTION	30.08.23	1:100 @ A1	2273	003-FEP	C02											
<p>Pure Gym Ltd        Town Centre House        The Merrion Centre        Leeds        LS2 8LY        e: architecture@puregym.com        t: 0113 285 8787        w: www.puregym.com</p>																